

This tutorial instructs you on how to create parallax scrolling.

Parallax Scrolling will make the background layer photo move slower than the foreground layers when scrolling.

Step 1

To make the background photo do parallax scrolling, hover over the slide and click the settings icon.

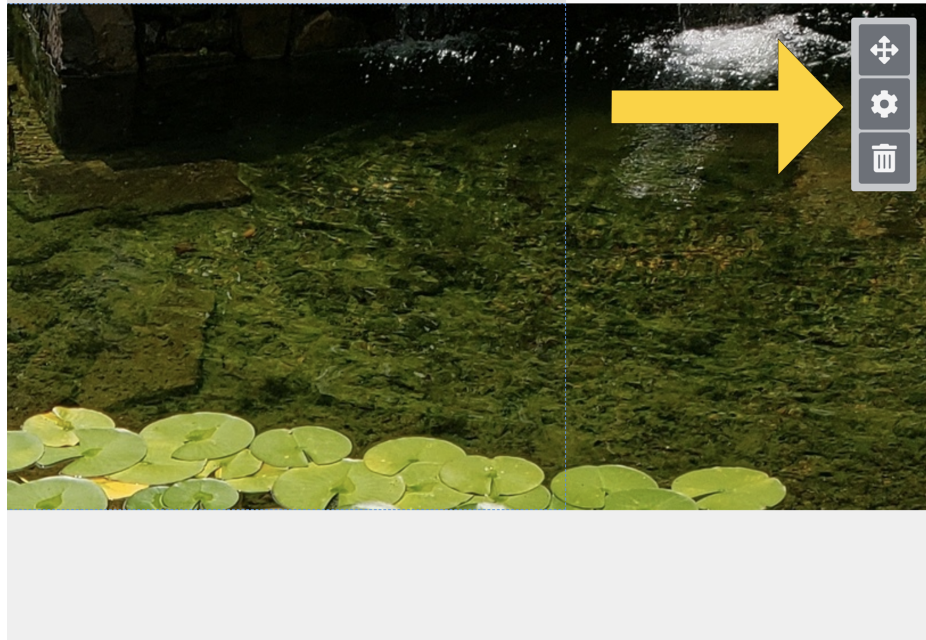

Step 2

Under bottom layer background, click select image.

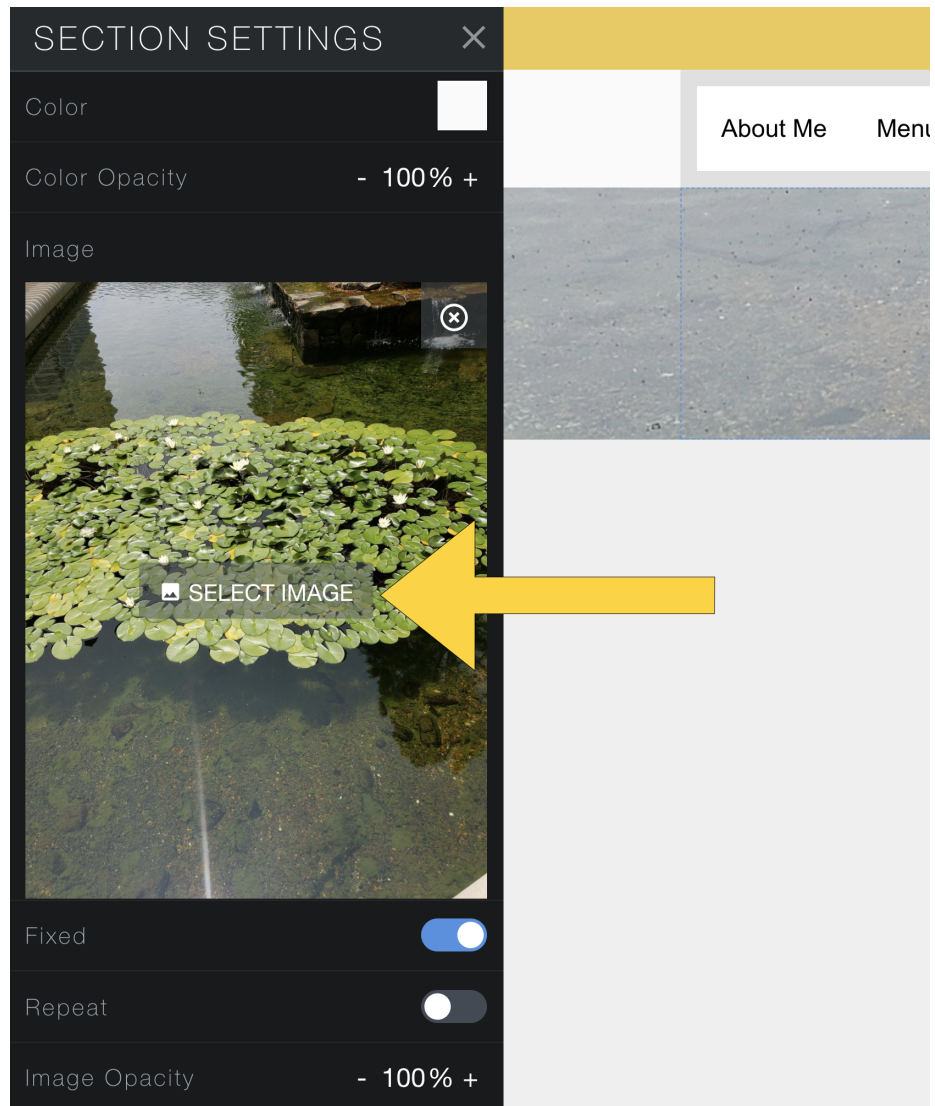

Step 3

You can either select a photo by going to previous uploads or upload a new file.

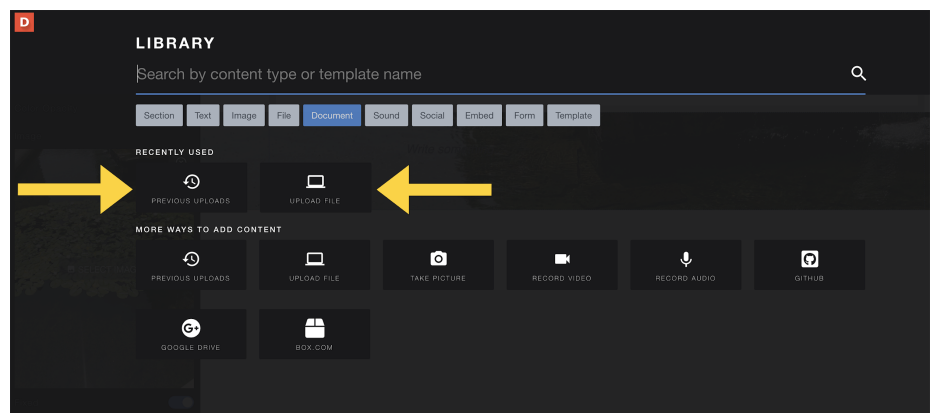

Step 4

Select the image you want to upload.

PREVIOUS UPLOADS

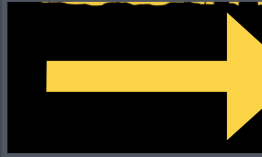

Fall_Background.png

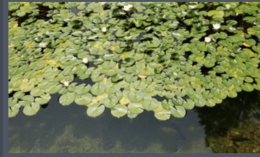

20190603_124351.jpg



20190530_203537.jpg



20170510_135040.jpg



20190422_173351.jpg



20170510_135035.jpg

Step 5

To make the image able to do parallax scrolling, click the button next to fixed. When it is turned on, it is blue.

SECTION SETTINGS

Color



Color Opacity

- 100% +

Image



Fixed



Repeat



Image Opacity

- 100% +

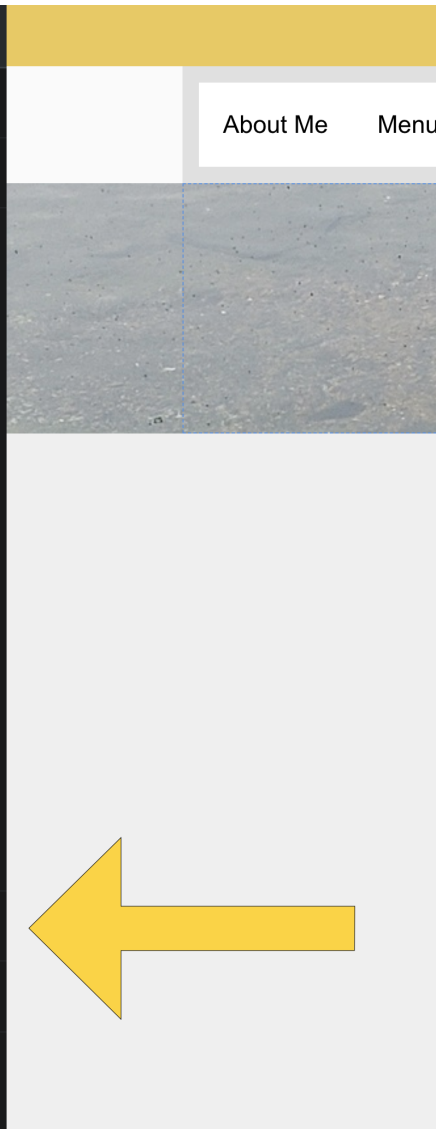

Step 6

To ensure that the photo extends as long as you would like, you may need to increase the size of the blank text box on top of the photo.

